

REV	Date	Description	Initials
P	22/03/19	Amended as per clients comments	KC

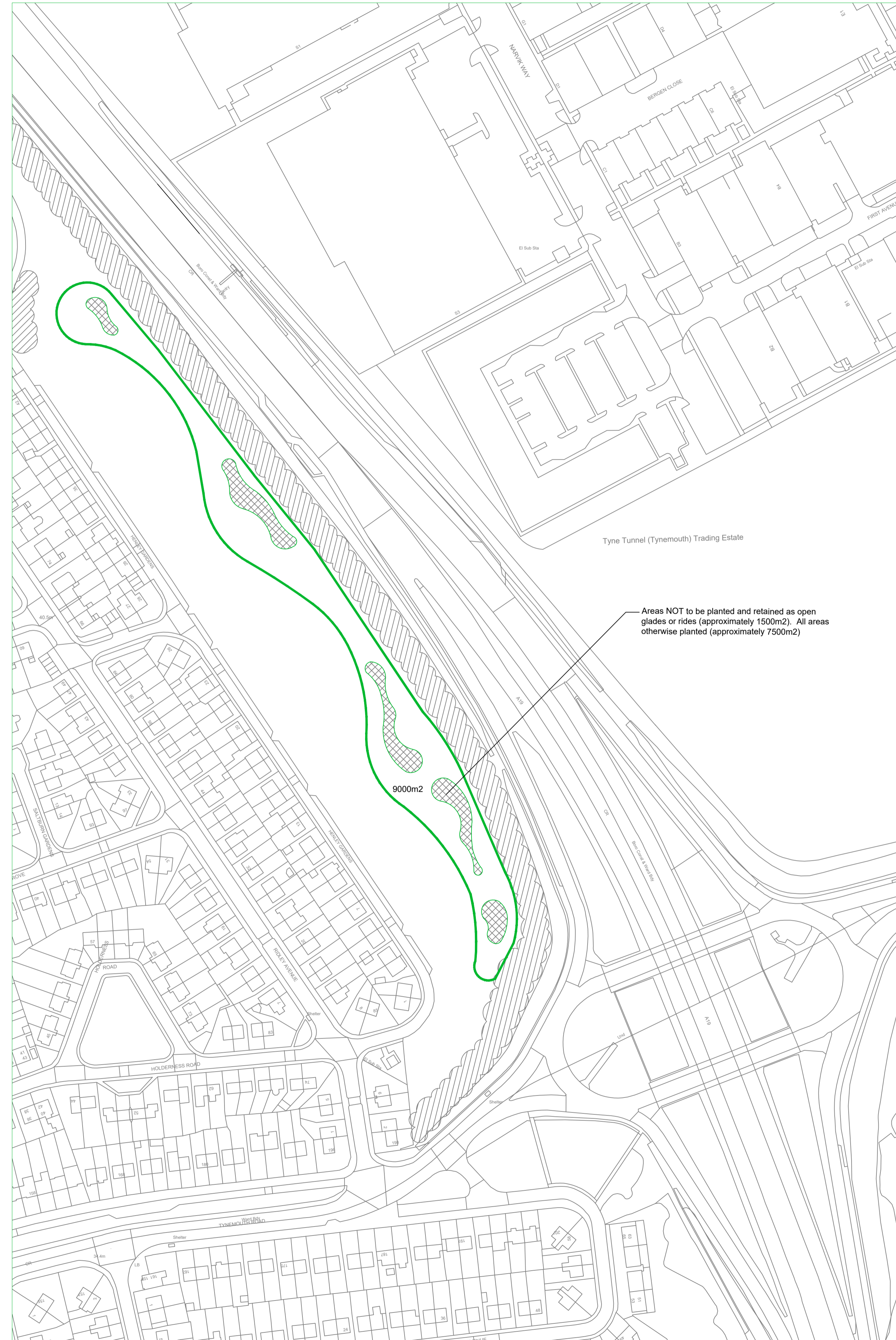

Areas NOT to be planted and retained as open glades or rides (approximately 1500m2). All areas otherwise planted (approximately 7500m2)

9000m2

PLANTING SPECIFICATION

TOTAL 1200no.

120no.	10%	ACER CAMPESTRE	1+1	Branched	60-80	br
240no.	20%	BETULA PENDULA	1+1	Branched	60-80	br
120no.	10%	CRATAEGUS MONOGYNA	1+1	Bushy 3 breaks	60-80	br
25no.	2%	CORYLUS AVELLANA	1u1	Branched	60-80	br
120no.	10%	FAGUS SYLVATICA	1+1	Branched	60-80	br
60no.	5%	ILEX AQUIFOLIUM	3L	Bushy 3 breaks	60-80	ct
95no.	8%	PRUNUS AVIUM	1+1	Branched	60-80	br
35no.	3%	PRUNUS SPINOSA	1+1	Branched	60-80	br
240no.	20%	QUERCUS ROBUR	1u1	Branched	60-80	br
120no.	10%	SORBUS AUCUPARIA	1+1	Branched	60-80	br
25no.	2%	VIBURNUM OPULUS	1+1	Bushy 3 breaks	60-80	br

Native broadleaf planting at 2.5m centres with mulch mats and tree spirals;

KEY

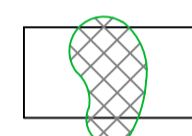
-  Proposed new native planting (7500m2)
-  Areas NOT to be planted (1500m2)

GENERAL: All soft landscaping should be carried out by specialist landscape sub-contractor. All plants shall conform to BS 3936 and be in accordance with the National Plant Specification and the specification details shown on this drawing. Supplying nurseries shall be registered under the HTA Nursery Certification Scheme. Bare root material is to be root wrapped and planted within 24 hours of lifting from the nursery and/or kept in the appropriate conditions if this time is to be extended in agreement with the Local Authority. All plants shall be packed and transported in accordance with the Code of Practice for Plant Handling as produced by the Committee for Plant Supply and Establishment (CPSE). Any plant material that does not meet the specification or schedule requirements shall be rejected and replaced at the landscape contractor's own expense. Planting shall not be carried out when the ground is waterlogged, frost-bound or during periods of cold drying winds.

All existing good quality top soil is to be incorporated into the landscape proposals where practicable. All trees and shrubs are to be inspected/ selected by the Landscape Architect from the source nurseries. All expenses for all nursery visits are to be allowed for by the landscape contractor. All plant material, setting out and finished grading is to be checked and approved by the Landscape Architect prior to commencement of planting. All planting is to be carried out during the first appropriate planting season following completion of all hard landscape works. All areas are to be thoroughly stone picked by hand before and after cultivations, with all stones >20mm removed along with all deleterious arisings. All landscape areas should remain free from waste material and rubbish at all times. All planting should arrive to site free of any pernicious weeds/moss/lichen. All plant material is to be thoroughly watered before packaging for delivery, on the day of planting (before planting) and again immediately following planting using a fine rose sprinkler to the full depth of the roots. All areas shall remain weed free both during construction and during the defects/maintenance period. All imported topsoil/ compost/ mulch material is to be inspected and approved in its original location by the Landscape Architect prior to delivery to site. For more detailed information all landscape works should comply fully with the following British Standards: BS 3882:2015 - Specifications for top soil; BS 3936:part 1:1992 - Nursery stock; BS 4043:1989 - Recommendations for transplanting root balled trees; BS 4428:1989 - Code of practice for general landscape operations; BS 5837:2012 - Trees in Relation to Construction; BS 5845:2014 - Trees: From Nursery to Independence in the Landscape

NOTES ON PLANTING
Each proposed planting pit is to be cleared of vegetation prior to planting. Transplants and Whips shall be planted in pits 300 x 300 x 300mm depth. Excavated material to be retained. Plant whip/transplants in to pit and back fill with a mix of excavated material and 3 litres Peat Free Tree and Shrub Compost. Remove stones exceeding 50mm in any dimension off site. Form the hole and avoid smearing the sides and causing compaction. Soil shall be carefully returned and firmed in around the root mass. Water each plant immediately after planting. Surplus material may be distributed around the planting station, unless otherwise directed. Each plant is to be protected with a tree spiral from Tubex or similar and approved. Type: Tubex Ecowrap (Product code 160PS1207-PRO); 60cm high with 600mm bamboo cane. Arrangements to be made to recycle after 3 years. All damaged grassed areas to be reinstated.

Mulch mats shall be installed for all tree and shrubs planted. Mats shall be biodegradable material: flax, jute or hessian, size 500 x 500 mm and laid in close contact with the ground surface to manufacturer's recommendations.

MAINTENANCE

Maintenance is for a period of 12 months from the date of Practical Completion. Include for the reinstatement and replacement of plants which are dead, dying or failed to show leaf as determined by the Landscape Architect during the defects liability period.

Whip/transplant areas: Apply an approved residual herbicide 3 times during the growing season to maintain a clear earth around the transplants at 450mm centres and 450mm diameter to each whip planted at 1.0m centres. Removing all arisings of site. Include for strimming weed 3 times during the growing season. Allow for 1no winter herbicide. Include for the removal of litter at each visit.

Inspect all plants and firm in - 1 no visit

Watering: Water all transplants - 2no visits

Litter removal: Allow for 2no additional litter picks to all areas.

THIS DRAWING IS COPYRIGHT. NO PART OF THIS DRAWING MAY BE REPRODUCED IN ANY FORM WITHOUT THE EXPRESS WRITTEN PERMISSION OF: NORTH TYNESIDE COUNCIL DESIGN SERVICES

DO NOT SCALE FROM THIS DRAWING. WORK FROM FIGURED DIMENSIONS ONLY. ANY DISCREPANCIES SHOULD BE REPORTED IMMEDIATELY TO THE DESIGNER.

COM- SAFETY, HEALTH & ENVIRONMENTAL INFORMATION
IN ADDITION TO THE HAZARDS/RISKS NORMALLY ASSOCIATED WITH THE TYPES OF WORK DETAILED ON THIS DRAWING.

DEPENDANT ON THE STAGE OF THIS DRAWING IF THE FOLLOWING PROJECT SPECIFIC RISKS ARE NOT DENOTED BUT REQUIRE ATTENTION/MITIGATION ALWAYS REFER TO DESIGNERS RISK ASSESSMENT.

PROJECT:
Phase 1

TITLE:

DRAWN:	PRELIMINARY
CHECKED:	PLANNING
SCALE:	BUILDING REGS:
DATE:	TENDER:
PROJECT REF:	CONSTRUCTION:
DWG NO:	AS BUILT:
Rev	