

## Brilliant Birdhouse

Give a bird a safe place to rest with items you would normally throw away. We used a juice carton, but many containers would work!

### STEP 1

- Cut a hole the size of a golf ball in your **clean carton** for the entrance.

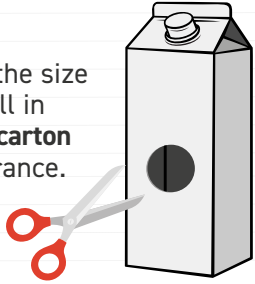

### STEP 4

- Tie some **string** at the top.

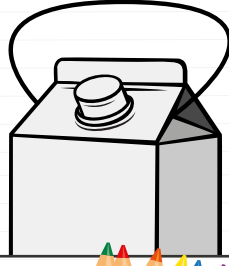

### STEP 2

- Cut a smaller hole at the bottom, just big enough for a twig to go through, and one more hole on the opposite side.

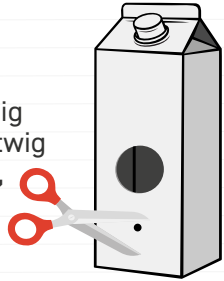

### STEP 5

- Get decorating!



### STEP 6

- Hang your birdhouse somewhere outside.



Remember birds like to be left alone, so no peeking if one comes to live in your birdhouse.

### STEP 3

- Feed a **twig** through the small holes so that it sticks out near the entrance.

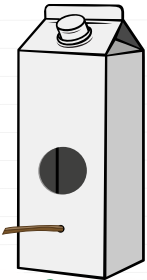

See more at [life.org.uk/life-at-home/WonderfulWorld](https://life.org.uk/life-at-home/WonderfulWorld)

If you like these activities and would like Life to contact you if we have other cool stuff to share, get an adult to drop us an email at [lifethome@life.org.uk](mailto:lifethome@life.org.uk)

We will only use this email address for the purpose of sending free activities or opportunities and won't hold your details for more than 24 months.

Life Science Centre has a packed summer of activities for you to try at home.



This week we're connecting with nature and exploring our...

# Wonderful World

Take home the joy of being outside with three fun makes!



In partnership with

Newcastle City Council

Gateshead Council



South Tyneside Council

## Make a Pooter!

Explore the wonderful world of tiny bugs and insects.

### STEP 1

- Take a **clear plastic tub** with an **airtight lid**. A tub for dips is ideal.

### STEP 2

- Carefully push a **sharp pencil** through the sides of the tub to leave two holes.

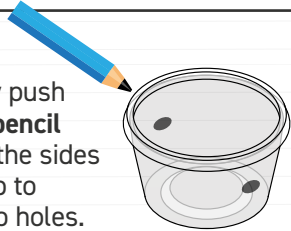

### STEP 3

- Push a **straw** through one hole, making it airtight using **plasticine** or **tape**.

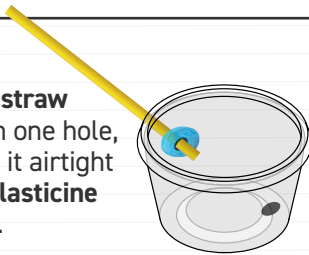

### STEP 4

- Cover the end of the straw inside the tub with **thin fabric** (tights are perfect) and tape it securely around the straw.



### STEP 5

- Push a **wide straw** through the other hole making it airtight like the first one.

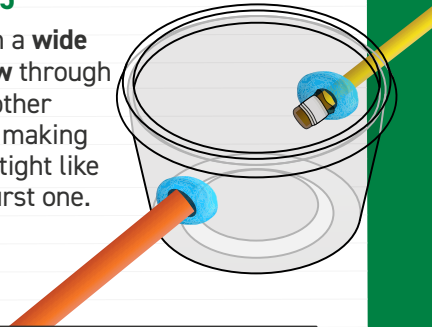

### STEP 6

- Put the lid on your tub.

When you find small bugs, place the wide straw near them and suck quickly through the other straw. The bug should get sucked up inside the tub where you can watch it closely. The fabric stops the bug coming up the other straw!

You might like to draw your bug, identify it or make other observations.

Make sure to put the bug back safely when you've finished observing it.

If you're fascinated by bugs and minibeasts follow this link to look up the 'buglife' website for identification tips



## Make your own Herbarium

Create a catalogue of leaves and see how different they look.

### STEP 1

- Go out collecting **leaves** of all shapes and sizes – the more variety, the better!



### STEP 4

- Cover with another sheet of newspaper and piece of cardboard.

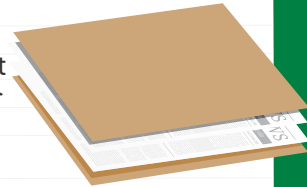

### STEP 2

- Lay a piece of **cardboard** out and place a sheet from an **old newspaper** on top.

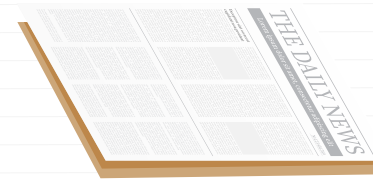

### STEP 5

- Add something heavy on top and leave to dry.



### STEP 6

- Wait a few days before checking your plants; if they are not dry, change the newspaper and wait some more.

### STEP 3

- Arrange a few of your leaves on the newspaper so that they are as flat as possible.



### STEP 7

- Once dry, gently **glue** or **tape** the leaves on a piece of **card**.



Plant scientists add labels to their herbarium samples with information on where and when they have collected them.